

Specifications

SMART Mobile Stand for interactive flat panels

Model FSSBID 100

Overview

The SMART Mobile Stand for interactive flat panels is height adjustable and includes integrated speakers, a locking cabinet to secure equipment, casters that swivel and lock for easy movement, and a cabling and power-distribution system for the interactive flat panel and connected peripheral devices.

See smarttech.com/supportedpanels for the order numbers, shipping sizes and weights of SMART Board® interactive flat panels and other SMART interactive products supported by the SMART Mobile Stand.

See smarttech.com/businessaccessories for more information on the SMART Mobile Stand and other accessories for your SMART interactive product.



Dimensions and weights¹

Dimensions

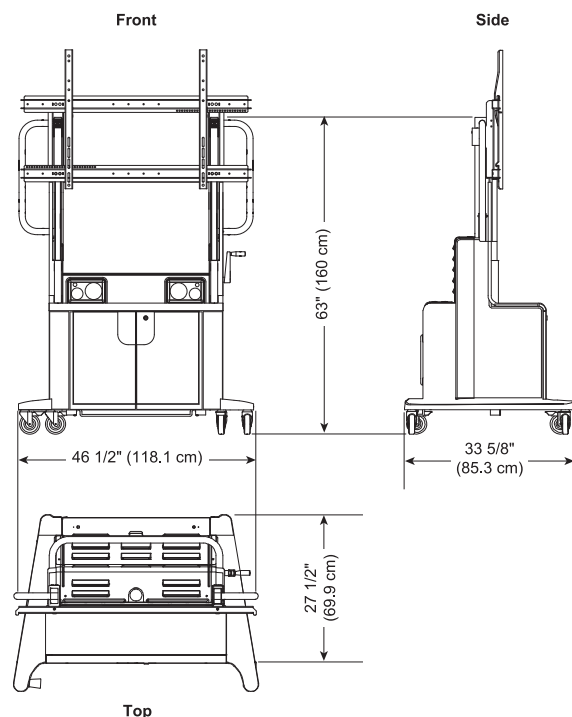

Mobile stand weight

252 lb. (114.3 kg)

Interactive flat panel weight

Minimum: 90 lb. (40.8 kg)

Maximum: 265 lb. (120.2 kg)

Shipping dimensions

(1 unit on included pallet)

51" W × 69" H × 40" D

(130 cm × 175 cm × 102 cm)

Shipping weight

340 lb. (154.2 kg)

¹ All dimensions ± 1/8" (0.3 cm). All weights ± 2 lb. (0.9 kg).

SPECIFICATIONS

SMART Mobile Stand for interactive flat panels – Model FSSBID 100

Standard features

General

Mounting brackets	Universal mounting brackets with locking safety clips, securing compatible SMART interactive products to the mobile stand
Height adjustment	Two-piston hydraulic system Height adjustment over a range of 15 3/4" (40 cm) ²
Mobility	Four 5" (13 cm) heavy duty, non-marking, locking casters One horizontal and two vertical grab bars, enabling you to easily move the unit
Stability	Wide footprint and reinforced steel design for excellent stability when writing on or touching your SMART interactive product
Ventilation	Rear and bottom venting for peripheral devices
Cable management	Pre-wired cable bundle, enabling you to connect peripheral devices to your SMART interactive product Centralized cable management with strain relief
Audio	Integrated 20 W speakers
Cabinet	Durable, high-quality, dent-resistant and easy-to-clean finish
Shelving	Two vertically adjustable shelves, with shelf spacing ranging from 2" to 19" (5.1 cm to 48.3 cm)
Computer and rack mount support	Can accommodate a 7 1/2" × 18" × 18" (19.1 cm × 45.7 cm × 45.7 cm) computer tower Can be easily configured for a 19" (48.3 cm) rack mount ³
Security	Sturdy locking cabinet with solid doors providing secure storage
Removable rear access panels	Easy access to peripheral devices for cable installation and power management
Security	Tamper-proof, self-tapping TORX® key hardware

Connectors

Internal

Desktop computer	VGA video 3.5 mm stereo audio USB for SMART interactive product touch control and two additional USB devices ⁴
Audio/video	Component video with stereo audio (5 × RCA) Composite video with stereo audio (3 × RCA)

²When you mount a large SMART interactive product, such as a SMART Board 8070i interactive flat panel, on the mobile stand a locking pin limits the height adjustment to a range of 10 5/8" (27 cm).

³If you want to configure your mobile stand for a rack mount, purchase a hardware accessory kit from your authorized SMART reseller (smarttech.com/where).

⁴You need at least three USB receptacles on your computer to connect it to your mobile stand. If your computer has fewer than three USB receptacles, you need a USB 2.0 hub (not included) to connect your computer to your mobile stand.

Rear connection panel

Laptop (optional)	VGA video 3.5 mm stereo audio USB 2.0 for SMART interactive product touch control
Peripheral devices	USB 2.0 for your SMART Document Camera™, SMART Response™ interactive response system receiver and other peripheral devices
One + one cabling	Connections for power and network support, enabling you to easily connect cables and disconnect them when you need to move the unit

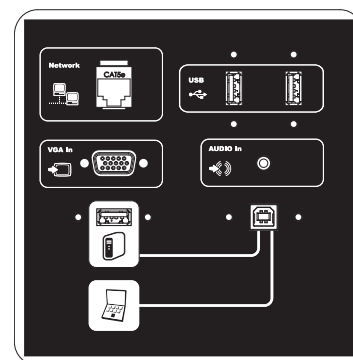
**Power specifications**

Specifications	Accommodates 1.2 kW
Power bars	NEMA (North America) 110V AC OR IEC 240V, 50 Hz (Europe and China)
Power cord	8' (2.44 m) country-specific power cord with cable management feature
Additional power	Power access for additional devices near the bottom rear of the stand

Storage and operating requirements

Storage	-40°F to 140°F (-40°C to 60°C)
Operation	41°F to 86°F (5°C to 30°C) with up to 80% relative humidity, non-condensing

Certification and compliance

CB, CSA/CE, RoHS and WEEE

Purchasing information

Order numbers	
FSSBID 100	SMART Mobile Stand for interactive flat panels
FSSBID RACK MT	Rack mount hardware accessory kit, including 16 rack clips
Warranty	One-year limited equipment warranty on the stand, height-adjustment mechanism and cabinet

smarttech.com/support
smarttech.com/contactsupport

© 2010–2014 SMART Technologies ULC. All rights reserved. SMART Board, SMART Document Camera, SMART Response, smarttech, the SMART logo and all SMART taglines are trademarks or registered trademarks of SMART Technologies ULC in the U.S. and/or other countries. All third-party product and company names may be trademarks of their respective owners. This product and/or use thereof covered by one or more of the following U.S. patents. www.smarttech.com/patents. Contents are subject to change without notice. 01/2014.