

FS-UX-LTS – Laptop Shelf for SMART Mobile Height-Adjustable Floor Stand

SMART Product Registration

By registering your product, you help us improve our products and services.

Name: _____
 Address: _____
 City: _____
 State: _____
 Zip: _____
 Country: _____
 Phone: _____
 Email: _____

Product Name: FS-UX-LTS
 Product Number: _____
 Date of Purchase: _____

Thank you for your purchase!

SMART Limited Equipment Warranty

This warranty is limited to the original purchaser of the product. It does not cover any damage caused by misuse, accident, fire, flood, theft, or other causes outside of normal use. The warranty is void if the product is used for any purpose other than that intended by SMART. SMART is not responsible for any damage to the product caused by the use of non-SMART accessories or modifications. This warranty is limited to the repair or replacement of the product at SMART's discretion. SMART is not responsible for any damage to the product caused by the use of non-SMART accessories or modifications. This warranty is limited to the repair or replacement of the product at SMART's discretion.

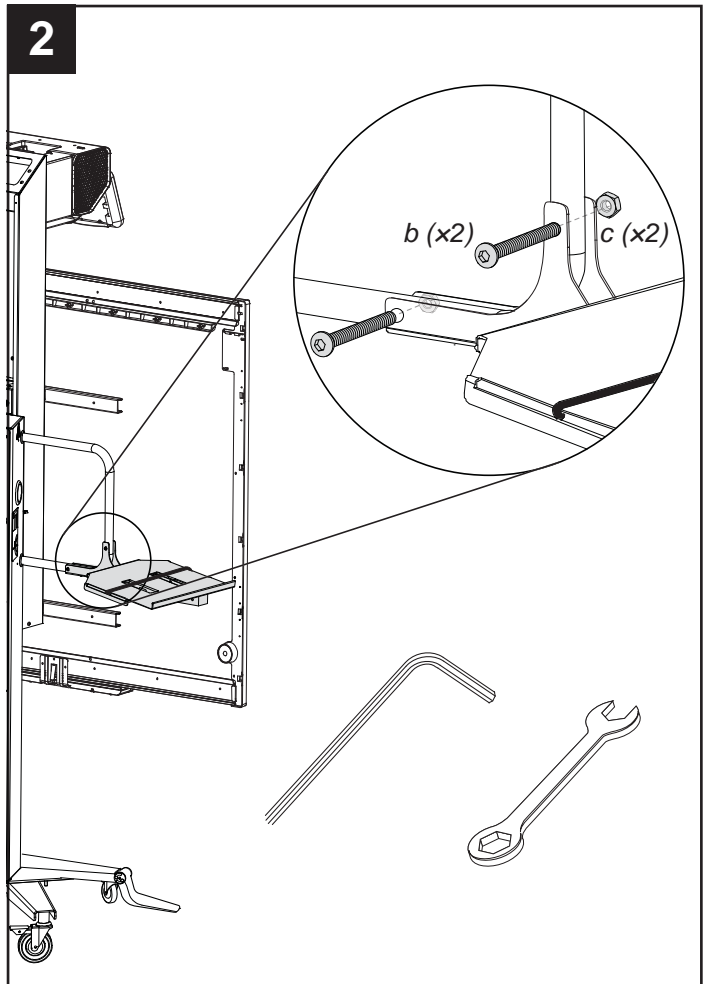
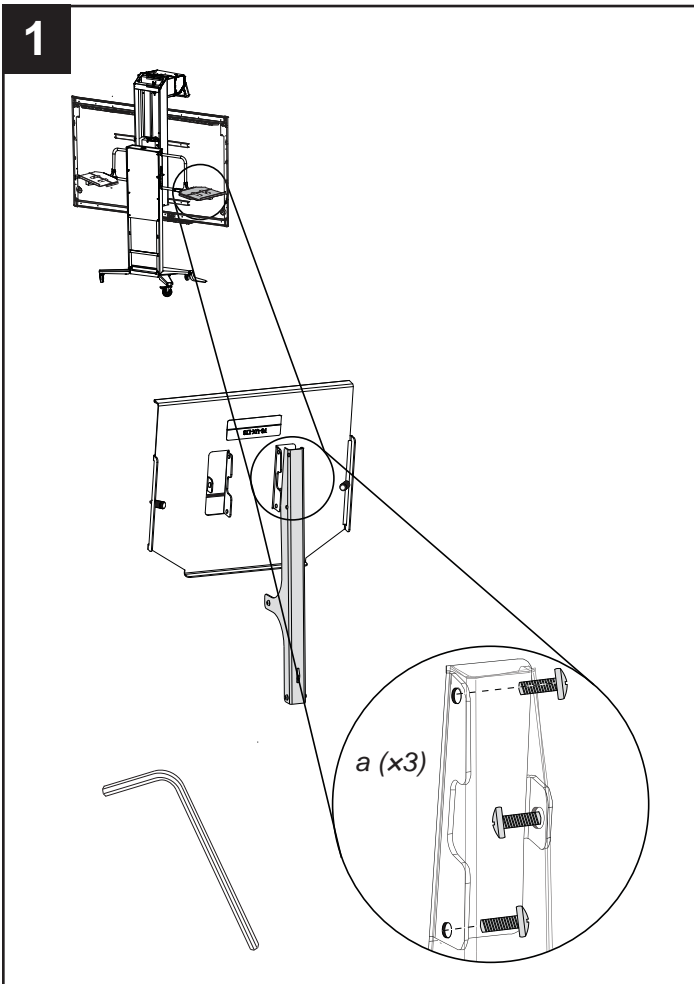

3

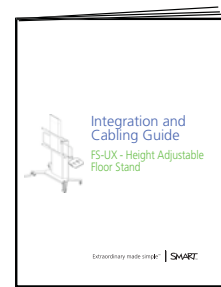
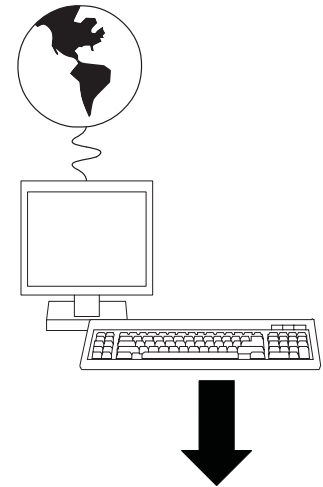
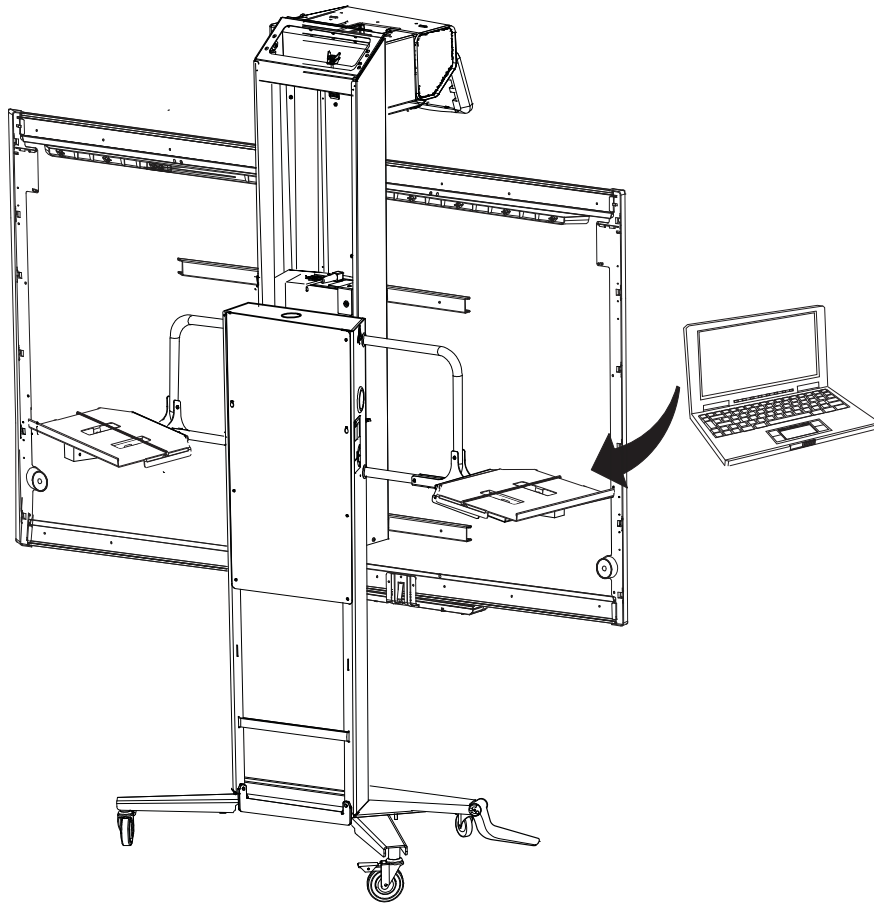

www.smarttech.com/kb/147510



Waste Electrical and Electronic Equipment Regulations

This section contains information about the Waste Electrical and Electronic Equipment Regulations (WEEE) that apply to all electrical and electronic equipment within the European Union.

When you dispose of any electrical or electronic equipment, including SMART products, we strongly encourage you to contact your local WEEE recycling agency for recycling and disposal advice.

Your SMART product required the extraction and use of natural resources for its production. It may contain hazardous substances.

By disposing of electrical and electronic equipment appropriately, you lower the impact of these substances upon health and the environment and reduce the pressure on natural resources. Recycling agencies can reuse or recycle most of the materials from your product.

Please think about how you intend to dispose of any product that has a WEEE symbol or accompanying WEEE guidelines.

If you need more information on the collection, reuse and recycling of electrical and electronic equipment, please contact your local WEEE recycling agency. Alternatively, contact your local reseller or SMART Technologies for information on the environmental performance of our products.



www.smarttech.com/support www.smarttech.com/contactsupport
 Support +1.403.228.5940 or Toll Free 1.866.518.6791 (U.S./Canada)



© 2010 SMART Technologies ULC. All rights reserved. SMART Board, the SMART logo, smarttech and all SMART taglines are trademarks or registered trademarks of SMART Technologies ULC in the U.S. and/or other countries. All third-party products and company names may be trademarks of their respective owners. Patents pending. Contents are subject to change without notice. 10/2010.

99-01133-20 A0