



SMART Board™ 885ixe interactive whiteboard system

It's all about collaboration

The 885ixe system facilitates an interactive collaboration experience that can lead to increased understanding, faster and more informed decision making and energized participation with co-workers, whether they are in the same room or joining from remote locations. And its ease-of-use helps facilitate the rapid adoption of the system by your team.

The 885ixe system enhances the way your teams work together, leading to increased effectiveness and efficiency for any business. With the press of one button, two or more people can immediately begin brainstorming through on-demand functions like whiteboarding, web browsing and PDF viewing. And the system's ease-of-use, full integration and reliability accelerate its adoption into everyday processes.

Discover new ways to drive business productivity

Collaboration sessions can begin immediately on the 885ixe system. Team members can hold interactive brainstorming sessions using the whiteboarding function, browse the Web and view PDFs. All meeting notes and annotations can be saved to a pre-configured network drive, a USB flash drive or a connected laptop, and they can also be distributed via e-mail. And it's easy for remote participants to join in on these sessions in an interactive way. These benefits, combined with its ease-of-use, help to facilitate your teams' rapid adoption of the 885ixe system and increase their productivity.

Enhanced security, reduced system maintenance

The 885ixe is a fully integrated, appliance-based system designed for environments without an in-room computer or where there is little reliance on IT support. Its simplified, on-demand functions, quick and easy laptop connection and locked-down system design minimize IT support requirements and increase reliability. And while meeting notes can be saved anytime to a network location or a USB flash drive, or distributed via e-mail, the system does not keep any residual data, preventing those in a meeting room from accessing confidential information from previous meetings.

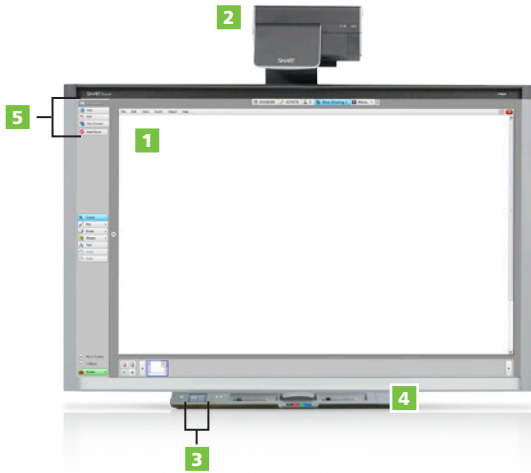

- 1 SMART Board interactive whiteboard – a multitouch interactive whiteboard that enables two people to simultaneously write, erase and manipulate content
- 2 SMART UX60 projector – an integrated, ultra-short-throw WXGA (1280 x 800) projector with a 16:10 aspect ratio. The SMART UX60 has a 12" (30.5 cm) optical throw distance to the interactive whiteboard surface. It's HD-ready and supports the system's widescreen format.
- 3 Appliance control panel – turn the 885ix system on by touching one button on the panel. An LCD display is embedded in the panel, as well as a USB port
- 4 Multiuser Pen Tray – the advanced Pen Tray automatically detects the tool selected. It also has two wings on the side that enable you to add accessories, such as the extended control panel
- 5 On-demand functions – begin collaboration sessions immediately after turning the system on by having instant access to whiteboarding, web-browsing and PDF-viewing functions

Features

Intuitive on-demand functions

Easily access whiteboarding, web-browsing and PDF-viewing functions immediately after turning the system on.

Appliance control panel

One-button-on design with LCD display and USB port.

Natural user interface

Simply touch the interactive whiteboard with your finger – no special tools required. One person can use two fingers to gesture, or two people can touch at one time.

Freestyle interaction

Two people can work together anywhere on the interactive whiteboard. It's a seamless, natural experience – just start writing or moving objects.

Touch gestures

Convenient, creative shortcuts for working with content include one- and two-finger navigational gestures (e.g., panning, flicking pages), object gestures (e.g., zooming, tossing, rotating) and other gestures supported by multitouch operating systems.

Object awareness

Enables natural movements that close the gap between the physical and digital worlds. The interactive whiteboard automatically recognizes when you switch between using a finger, pen or the eraser. You can even use your fist as an eraser, just as you might on a blackboard.

SMART Ink™

Just pick up a pen and start writing. It's a natural, accurate and smooth writing experience. SMART Ink intelligently smoothes a user's handwriting to improve legibility, and supports annotation over any application. Inject digital ink as text or images into Microsoft® Office applications and Adobe® Acrobat® Professional.

Multiuser Pen Tray

Pick up one of the pens or the eraser, and the Pen Tray automatically detects which tool you've selected. Buttons on the Pen Tray select the color and launch the On-Screen Keyboard, right-click and help functions.

Business aesthetics

The system integrates easily into collaborative workspaces.

Specifications

Size

78 1/2" W x 53 3/8" H x 6 1/2" D
(199.4 x 135.6 x 16.5 cm)

Active screen area

(maximum interactive projected image)
74" W x 46 1/42" H (188 x 117.5 cm)
87" (221 cm) diagonal, 16:10 aspect ratio

Weight

69 lb. 8 oz. (31.5 kg)

Shipping size

87 3/4" W x 56 1/8" H x 4 3/8" D
(222.9 x 142.6 x 11.1 cm)

Shipping weight

100 lb. (45.4 kg)

SMART UX60 projector

Projector size

17 3/8" W x 10 1/2" H x 16 1/2" D
(44.1 x 26.7 x 41.9 cm)

Remote control

1 5/8" W x 3 3/8" H x 1/4" D
(4.1 x 8.6 x 0.6 cm)

Weight

22 lb. (10 kg)

Shipping weight

38 lb. 6 oz. (17.4 kg)

Shipping size

18 3/4" W x 18 1/8" H x 22 5/8" D
(47.6 x 46 x 57.5 cm)

Authorized reseller:

SMART Technologies

Toll free 1.866.518.6791 (U.S./Canada)

or +1.403.245.0333

smarttech.com