

# Rear Projection SMART Board™ Interactive Whiteboard

## Specifications – Model 4000i

### Physical Specifications

<b>Size</b>	Rear Projection SMART Board Interactive Whiteboard	57 3/8" W × 79 1/8" H × 29 1/8" D (145.8 cm × 201.0 cm × 74.0 cm)
	Active Screen Area	52 3/4" W × 39 5/8" H (134.0 cm × 100.7 cm) (4:3 aspect ratio) 66" diagonal (167.6 cm)
<b>Weight</b>	Rear Projection SMART Board Interactive Whiteboard (with projector)	471 lb. (213.6 kg)
<b>Shipping Size</b>	Cardboard Crate	62" W × 88" H × 43" D (157.5 cm × 223.5 cm × 109.2 cm)
<b>Shipping Weight</b>	Cardboard Crate	658 lb. (298.5 kg)

All dimensions +/- 1/8" (0.3 cm). All weights +/- 15 lb. (6.8 kg).

### Standard Features

<b>Software</b>	SMART Board software and Notebook™ software. Free software upgrades are available at <a href="http://www.smarttech.com/support/software/index.asp">www.smarttech.com/support/software/index.asp</a> .
<b>Cabinet</b>	Secure, fully enclosed cabinet with locking front doors. Easy access to multimedia equipment. Streamlite™ design with tapered shape, metal and plastic composite construction.
<b>Portability</b>	Roll-about, self-contained unit. Easy to move through doors as small as 80" H × 32" W (203.2 cm × 81.3 cm). 3" (7.6 cm) locking casters.
<b>Wireless Keyboard</b>	U.S. English Windows® compatible with built-in trackball (all regions except Japan). Holder provided on the side of the cabinet.
<b>Front Projector Controls</b>	Built-in projector controls on front of cabinet
<b>Audio</b>	Stereo amplified speakers
<b>Computer Connection</b>	An integrated serial cable and a 2' 6" (76.2 cm) SMART USB adapter cable are included
<b>Power Consumption</b>	Approximately 700 watts for the projector, audio and controller electronics. This 700-watt estimate does not include the internal computer, guest computer or other optional components such as a VCR or DVD player.
<b>Certifications</b>	CSA (Canada/U.S.)/CE
<b>Warranty</b>	Two-year limited equipment warranty on screen, cabinet and projector. 90-day warranty on the projector lamp. Projector and lamp warranty provided by Epson®.

### Integrated Projector

<b>Display Type</b>	SXGA+ (1400 × 1050) Epson PowerLite® 9300i with short-throw lens
<b>Display Technology</b>	3 × 1.4" (3.6 cm) polysilicon LCD panels
<b>Brightness</b>	2500 ANSI Lumens
<b>Contrast Ratio</b>	1100:1
<b>Lamp</b>	200 watt, up to 7,000-hour lamp life (user changeable)
<b>Scanning Rates</b>	H-sync 15 kHz–107 kHz; V-sync 50 Hz–120 Hz
<b>Video Compatibility</b>	NTSC, NTSC 4.43, PAL, PAL-60, M-PAL, N-PAL, SECAM
<b>RGB Signal Compatibility</b>	SXGA, XGA, UXGA, SVGA, VGA, MAC, IBM, VESA, SUN, SGI, HP
<b>Projector Support</b>	Replacement projector and repair service provided by Epson for the duration of the warranty period.

### Interactive Whiteboard Features

<b>SMART Pen Tray</b>	Optical sensors in the pen tray detect when a pen or the eraser is lifted from the tray. Four Whisper-tip™ pens (black, blue, red and green) and an eraser are included.
<b>SMART Super Screen</b>	Diffusion screen with uniform light distribution. Suitable for high ambient lighting.
<b>Digitizing Technology</b>	DViT™ (Digital Vision Touch) technology uses digital cameras to track an object interacting with a display surface

### Integration Features

<b>SMART X-Port™ 20 Switch</b>	Automatically switches the audio, video and serial connections to an alternate computer (Windows operating system or Macintosh computer). Comes wired with power, audio, video and serial cables.
--------------------------------	---

**Side Shelf** 16" W × 11" D (40.6 cm × 27.9 cm) shelf for a guest laptop. You can mount this shelf on either side of the cabinet.

**Video Camera Platform** The top of the cabinet can hold a video camera, or you can order an optional videoconferencing shelf

#### Rear Connection Panel

##### Input Terminals

- DB25 (F) printer parallel port
- RJ-45 (F) network
- RCA (F) composite
- Dual RCA (F) audio
- S-video (F)
- 3.5 mm mini-stereo (F)
- HB15 (F) computer 2 input
- DB9 (F) computer serial

##### Output Terminals

- Dual RCA (F)
- HD15 (F) RGB

## Specifications – Model 4000i

### Accessories Included

Infrared remote control for the projector and two AA batteries  
Wireless keyboard (English Windows operating system) and two AA batteries  
*Rear Projection SMART Board 4000i Installation Guide*  
*Epson PowerLite 9300i User's Manual*  
Network connection panel and cables for laptop computers including a J-hook for cable management

### SMART Board Software 9.5 Computer Requirements

**Windows Computers** Pentium® II 450 MHz processor  
128 MB of RAM (256 MB recommended)  
136 MB of free hard disk space for minimum installation (511 MB for full installation with Gallery collections)  
Windows NT® 4.0 (SP6), Windows 98 operating system or later  
Microsoft Internet Explorer® 6.0 or later  
Macromedia® Flash® player version 8

**NOTE:** The AirLiner™ wireless slate requires the Windows 2000 or Windows XP operating system.

**Requirements for SMART Video Player** Pentium II 450 MHz processor (700 MHz or faster recommended)  
Windows 98 operating system or later. Does not run on the Windows NT operating system.  
Microsoft® DirectX® technology 8.1 or later

**Mac Computers** 700 MHz processor (1 GHz or faster recommended)  
128 MB of RAM (256 MB recommended)  
Mac OS X versions 10.3.9 and 10.4.x  
148 MB of free hard disk space for minimum installation (423 MB for full installation with Gallery collections)  
Available powered USB port  
Safari 1.3.2 or later  
SMART Board software version 9.5 supports Intel processors (Universal Binary)  
**NOTE:** Previous versions of SMART Board software are compatible with earlier versions of the Mac OS X operating system. To download a previous version of SMART Board software, go to [www.smarttech.com/support/software/sb\\_mac\\_other.asp](http://www.smarttech.com/support/software/sb_mac_other.asp).

**Video Card** To take advantage of the SXGA+ projector, your video card must support a resolution of 1400 × 1050

### Storage and Operating Specifications (includes projector)

**Storage** 14°F to 95°F (-10°C to 35°C) with up to 80% humidity non-condensing  
**Operating** 41°F to 84°F (5°C to 29°C) with up to 80% humidity non-condensing

### Optional Accessories

**01-00159** Replacement projector lamp for the Epson PowerLite 9300i (Epson part number V13H010L26)  
**3000i-VC1** Large Videoconferencing Shelf  
**3000i-VC2** Small Videoconferencing Shelf  
**3000i-RCM** Room Control Module

### SMART Order Number

**RPSB 4000i-DV** *Rear Projection SMART Board 4000i interactive whiteboard*

**SMART Technologies Inc.**  
1207 – 11 Avenue SW, Suite 300  
Calgary, AB T3C 0M5  
CANADA  
Phone +1.403.245.0333  
Toll Free 1.888.42.SMART (Canada/U.S.)  
[info@smarttech.com](mailto:info@smarttech.com) [www.smarttech.com](http://www.smarttech.com)

**SMART**  
Technologies

© 2003–2006 SMART Technologies Inc. All rights reserved. SMART Board, Notebook, Streamlite, Whisper-tip, DVIT, X-Port, Airliner and the SMART logo are trademarks of SMART Technologies Inc. EPSON is a registered trademark of Seiko Epson Corporation, registered in the U.S. and other countries. Microsoft, Windows and Windows NT are registered trademarks of Microsoft Corporation in the U.S. and/or other countries. All other third-party product and company names may be trademarks of their respective owners. U.S. Patent Nos. 5,448,263; 6,141,000; 6,326,954; 6,337,681; 6,741,267; 6,747,636; 6,803,906; 6,919,880; 6,947,032; 6,954,197 and 6,972,401. Canadian Patent No. 2,058,219. Other U.S., Canadian and foreign patents pending. Specifications are subject to change without notice. 04/2006.

# Rear Projection SMART Board™ Interactive Whiteboard

## Specifications – Model 4000i

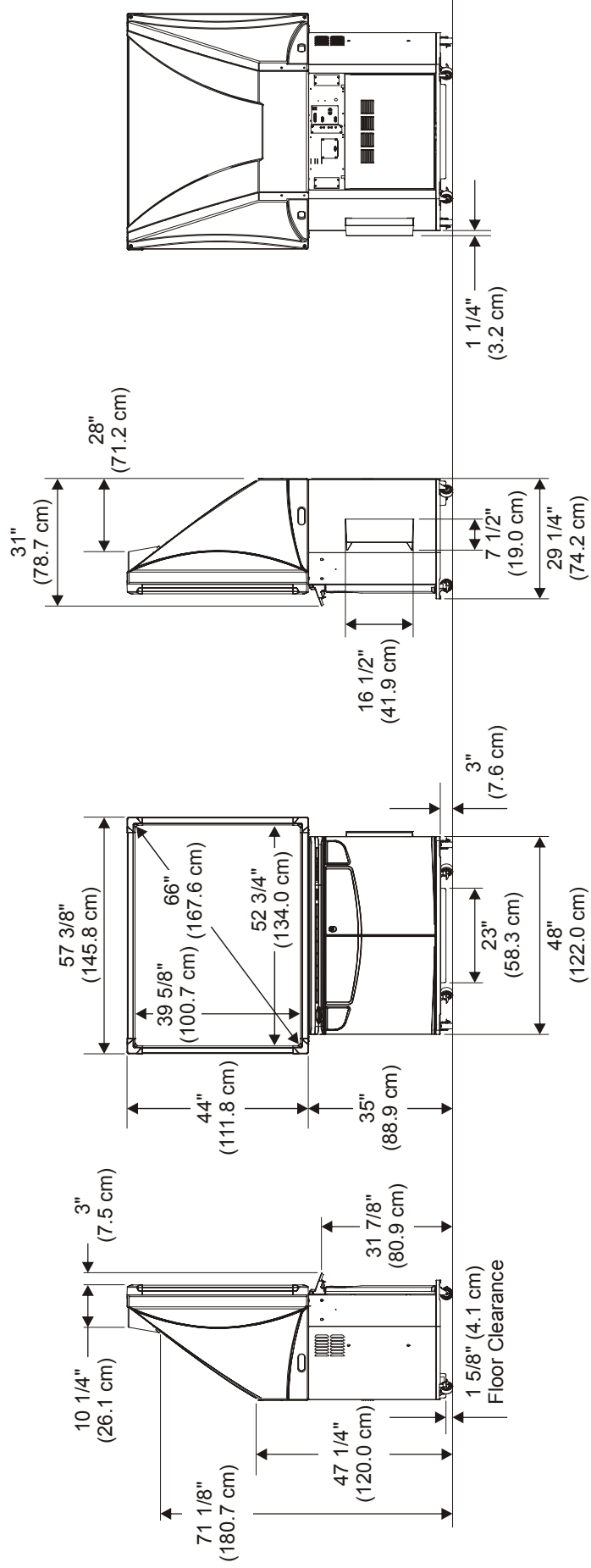
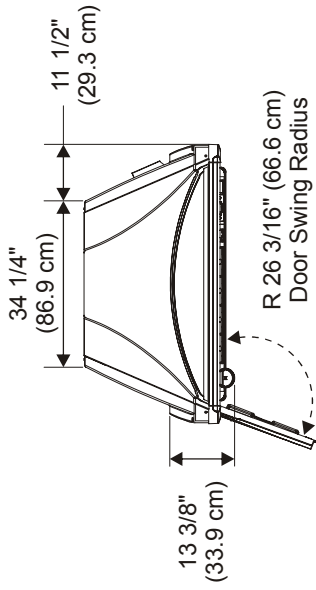

All dimensions +/- 1/8" (0.3 cm).